

Technical Data Sheet Sintofoil RG Membrane

Product Description:

Synthetic TPO/FPA waterproofing membrane designed for ballasted and mechanically fixed applications.

Produced by co-extruding a UV resistant elastomerised TPO/FPA thermoplastic olefin and flexible polypropylene alloy with a fibreglass reinforcing mat that makes it dimensionally stable.

The membrane features contrasting colours on its upper and lower faces.

Sintofoil RG membranes comply with CE/UKCA marking requirements, if applicable.

Field of Application:

- Ballasted waterproofing applied over suitable substrates for;
 - roof gardens (extensive / semi-intensive / intensive / brown / biodiverse)
 - ballasted roofs (paving slabs / stone ballast)
- Mechanically fixed waterproofing over suitable substrates for;
 - exposed roofs exposed to light (maintenance) foot traffic only
 - protected roofs (paving slabs / stone ballast)
- Refurbishment of appropriate existing bitumen waterproof coverings.

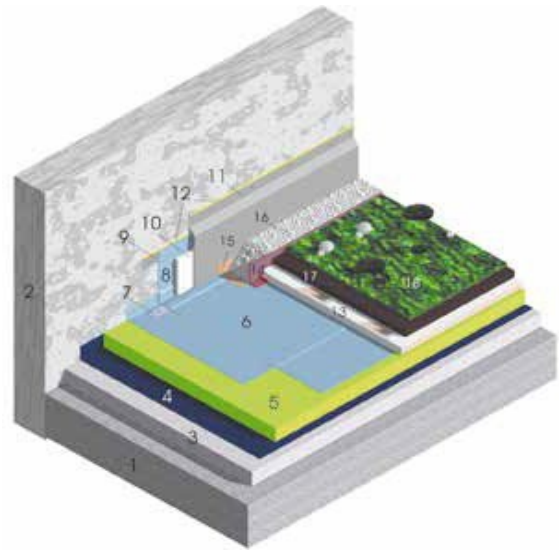

Certification:



NSAI

UK
NI
UK
CA



QMS certification according to ISO 9001.

This product can contribute to acquiring points in terms of BREEAM & LEED accreditation.

System Fire Testing:

Test Standard: CEN/TS 1187: 2012

Classification Standard BS EN 13501-5: 2016 – B_{ROOF} (t4)

warringtonfire

Determination of external fire performance is a system test which will be influenced by the components within the roofing system.

Whilst Sintofoil RG can be included in compliant B_{ROOF} (t4) systems, always check with MOY Technical Services for the latest information on testing carried out.



Technical Data Sheet

Sintofoil RG Membrane

Application:

Sintofoil membranes are designed for easy sealing of the laps, using an appropriate hot air gun set to the required welding temperature.

Design solutions and application methods are all as per the Sintofoil Installation Manual.

Waterproofing systems utilising Sintofoil membranes should only be laid by installers trained and authorised by MOY Materials Ltd.

Technical Specification:

TECHNICAL FEATURES ⁽¹⁾							
Features	EN Standards	U.M.	Tolerance	Values			
Standard thickness	1849-2	mm	(-5/+10%)	1.2	1.5	1.8	2.0
SRI – Solar Reflectance Index	ASTM Standard E1980	%		102 ⁽²⁾			
Tensile properties							
• Tensile strength L/T	12311-2	N/50 mm		600 / 550	650 / 600	750 / 750	800 / 800
• Elongation at break L/T	12311-2	%		700 / 700			
Dimensional stability	1107-2	%		≤ 0.1			
Cold flexibility	495/5	°C		≤ -40 ⁽³⁾			
Tear resistance L/T	12310/1	N		390 / 290	450 / 400	500 / 450	600 / 550
Water vapour permeability (resistance factor μ)	1931			50.000			
Resistance to static loading	12730/B	kg		≥ 25			
Resistance to impact	12691/B	mm		≥ 1000			
Hail resistance	13583	m/s		≥ 30 ⁽⁴⁾			
Water tightness (60 kPa)	1928			Absolute			
Joint strength							
• Tensile strength	12317-2	N/cm		Compliant (specimen fails outside bond area)			
• Peeling	12316-2	N/cm		≥ 58			
Durability							
• Resistance to artificial UV light	1297-5000 h			No surface damage or significant changes in cold flexibility as per EN 495/5			
Heat aging in area							
• Change in tensile strength	12311-2	Δ%		-5			
• Change in elongation at break	12311-2	Δ%		-5			
Wind load resistance (wind suction test) (UEAtc)							
• Mechanically retained system	Pa			≥ 6000			
Reaction to fire	13501-1			Class E ⁽⁵⁾			
Behaviour to external fire	13501-5			NPD ⁽⁶⁾			
Resistance to algae and microorganisms	ISO 846 Level 2			Compliant			
Root resistance	13948			Passes the test			

Notes:

(1) Tolerances as per EN 13956 and/or UEAtc Directives.

Technical Data Sheet

Sintofoil RG Membrane

- (2) Reflecta White version.
- (3) Not tested at lower temperatures.
- (4) Not tested at higher speeds.
- (5) Internal Report
- (6) Determination of external fire performance is a system test which can be influenced by system components, thus performance for each individual product cannot be given.

PRODUCTION STANDARDS

Thickness (*)	mm	1.2	1.5	1.8	2.0
Width	m	2.1	2.1	2.1	2.1
Length (*)	m	25	25	20	20
Colour		Grey / Black			

(*) Different thicknesses and lengths may be available on demand and for minimum quantities.

Delivery form:

Rolls.

Storage:

Rolls must be stored in their original package, horizontally on pallets and under cool and dry conditions between temperatures of +5 °C and +35 °C. They must be protected from direct sunlight, rain, snow and ice.

Safety:

Safety precautions to be taken when using this product are given in the Safety Data Sheet.

Disposal:

Information for this product are given in the Safety Data Sheet.