

## Technical Data Sheet MOY FI-R-20 Sleeve

### Product Description / Use:

The FI-R-20 is a thermally broken high-quality polyamide (PA-6) sleeve used for insulation and waterproof membrane securement.

Used with the BSA-70x70 stress plates for the securement of insulation, in the isoweld® field fastening system, or with compatible steel termination bars.

Sleeves suitable for use in combination with the appropriate carbon or stainless-steel screw fasteners, fixed into a range of deck types.

### Description:

- Heat resistant material for the isoweld induction system
- Sleeve tip enables pre-assembling with different fasteners
- Optimised sleeve tip for reduced penetration force
- Universal sleeve design suitable for compatible MOY fasteners

### Certification:



### Sleeve Product Range:

Code	L <sub>mm</sub>	Pack Quantity	Article Code
FI-R-20x40	40	500	1524375
FI-R-20x70	70	500	1524439
FI-R-20x100	100	500	1513274
FI-R-20x130	130	500	1524447
FI-R-20x160	160	250	1524449
FI-R-20x190	190	250	1524450
FI-R-20x230	230	250	1524462
FI-R-20x300	300	250	1524463

Packaging type: cardboard box

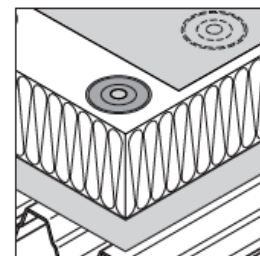
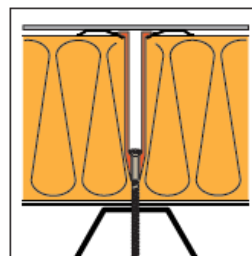
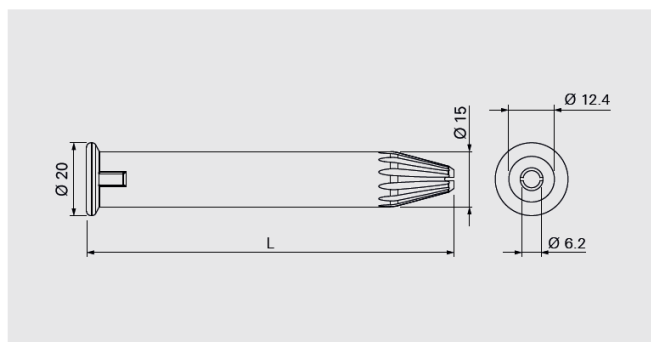









Overlap length between sleeve and fastener: 15mm

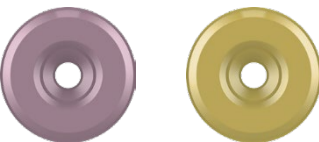

## Technical Data Sheet MOY FI-R-20 Sleeve

### Products to combine with:

Product Code	Description	
BS-4,8	Carbon steel fastener for steel deck, timber and timber-based boards	
BS-S-4,8	Stainless steel fastener for steel deck, timber and timber-based boards	
BS-6,1	Carbon steel fastener for steel deck, timber and timber-based boards	
TI-T25-6,3	Carbon steel fastener for concrete deck	
TI-S-Z10-6,3	Stainless steel fastener for concrete deck	
TIA-T25-6,3	Adjustable carbon steel fastener for tapered insulation on concrete deck	
TS-T25-6,0	Carbon steel fastener for timber, timber-based boards and concrete deck	
FI-P-16,0	Stress plates for PVC and TPO based waterproof membranes in combination with sleeve FI-R-20.	
BSA-P-70x70	For isoweld® field fastening application. Stress plate for insulation securement in combination with sleeve FI-R-20.	

### Installation:

In order to ensure the correct application of the tube & fastener combination into the substrate and to avoid overdriving and/or damage, all sleeves and fasteners must be installed using only the recommended tooling, including screw guns (with torque setting), drive bars and correct bits etc.

Minimum 25mm embedment into the concrete is required. The minimum penetration for steel and timber decks is 20mm and 30mm respectively (including the deck thickness).

Site pull-out tests required to confirm performance into any existing substrate on refurbishment projects and for both new and existing concrete decks.

MOY Materials Ltd has taken care to ensure that the information provided in the literature is correct and up to date. However, it is not intended to form any part of a contract or provide a guarantee. Purchasers/intending purchasers should contact MOY Technical to check whether there have been any changes to the information since publication of the literature. Please ensure you have read the hazard labels and material safety data sheet before using this product.